

FP 50 PLZ

Incasso da pavimento o parete con luce laterale a 1/2/4 uscite per esterni, in alluminio anodizzato con ghiera in acciaio AISI 316 L, completo di pressacavo.

Recessed floor or wall with side light with 1/2/4 outputs for outdoor use, anodized aluminum with steel ring AISI 316 L, complete with cable gland.



[Link](#)

SCHEMA MONTAGGIO
Installation instructions



FOTOMETRIE
Photometries

DIMENSIONI / SIZE

Ø 50mm h74,5mm

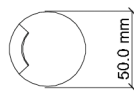

MATERIALE / MATERIAL

Ghiera in acciaio inox AISI 316
AISI 316 stainless steel ring

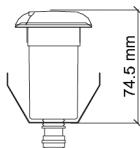

EMISSIONE/TYPE OF EMISSION

Luce laterale singola/doppia/quadrupla
Single/double/quadruple side lamp

LUNGHEZZA CAVO / LEVEL OF PROTECTION

Apparecchio fornito di serie con pressacavo e 0.30 metri di cavo
Supplied standard with cable gland and 0.30m exterior cable

GRADO DI PROTEZIONE / LEVEL OF PROTECTION

IP 65

INSTALLAZIONE / INSTALLATION

Fissaggio a terra
Ground fixing

DATI ILLUMINOTECNICI ED ELETTRICI / LIGHTING AND ELECTRICAL DATA

Parametri illuminotecnici elettrici ed ottici, secondo norma CEI EN 62722-2-1

Electrical and optical lighting parameters, according to the CEI EN 62722-2-1 standard

Sorgenti luminose	Light source	Led Star Mini XHP35
Temperatura di colore CCT	Color temperature CCT	3000K 4000K
Indice di resa cromatica Ra	Color Rendering coefficient Ra	>80
Deviazione cromatica Step MacAdam	Color deviation Step MacAdam	3
<hr/>		
Luce laterale singola	Single side lamp	FP50 PLZ 1
Ottiche	Optics	Single Side lamp
Flusso luminoso sorgente	Lumen light source	410 lm
Flusso effettivo	Actual flux	287 lm
Potenza	Power	4 W
Efficienza luminosa lm/W	Luminous efficiency lm/W	72 lm/W
Vtaggio*	Voltage*	12V DC
<hr/>		
Luce laterale doppia	Double side lamp	FP50 PLZ 2
Ottiche	Optics	Double Side lamp
Flusso luminoso sorgente	Lumen light source	2X 410 lm
Flusso effettivo	Actual flux	2X 287 lm
Potenza	Power	8 W
Efficienza luminosa lm/W	Luminous efficiency lm/W	72 lm/W
Vtaggio*	Voltage*	12V DC

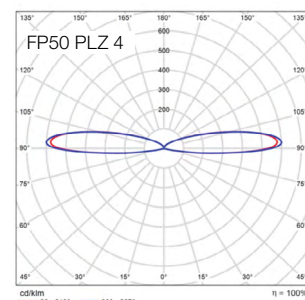
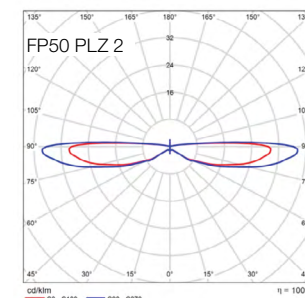
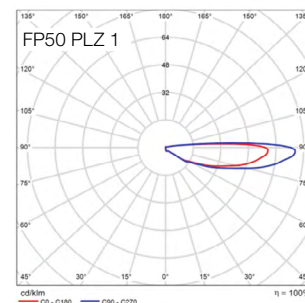

Luce laterale quadrupla	Quadruple side lamp	FP50 PLZ 4
Ottiche	Optics	Quadruple Side lamp
Flusso luminoso sorgente	Lumen light source	4X 410 lm
Flusso effettivo	Actual flux	4X 287 lm
Potenza	Power	16 W
Efficienza luminosa lm/W	Luminous efficiency lm/W	72 lm/W
Voltaggio*	Voltage*	12V DC
Temp.Tc@Ta 25°C	Temp.Tc@Ta 25°C	50°C
Temperatura standard ambiente esercizio:	Operating temperature	-20° +45°
Lifetime	Lifetime	L80 35.000h (Ta 25°C)

*Alimentatori a tensione costante o corrente da ordinare separatamente disponibili sia IP20 che IP67 idonei per installazione in esterni.
Disponibile interfaccia di dimmerazione Dali/Push/0-10V/ 1-10V

**Constant voltage ballasts to be ordered separately, both IP20 and IP67 are available and suitable for outdoor installation.
Dali/Push/0-10V/ 1-10V dimming interface available

ACCESSORI /ACCESSORIES

INC FP50

Controcassa in materiale plastico
Recessed box made of plastic material

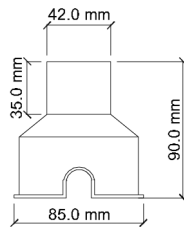

ESPLOSO /EXPLODED

- 1 - Flangia Aisi 316
- 2 - Cover opalino
- 3 - O-Ring Øint. 28mm
- 4 - Led Entity 350mA
- 5 - Dissipatore
- 6 - Elettronica driver 350mA
- 7 - Corpo spot
- 8 - Molla
- 9 - O-Ring Ø11.2
- 10 - Pressacavo ottone Pg7

- 1 - Flange Aisi 316
- 2 - Opali cover
- 3 - O-Ring Øint. 28mm
- 4 - Led Entity 350mA
- 5 - Heatsink
- 6 - 350mA driver electronics
- 7 - Spot body
- 8 - Spring
- 9 - O-Ring Ø11.2
- 10 - Brass cable gland

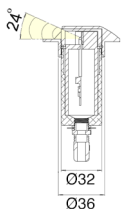
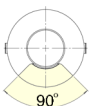
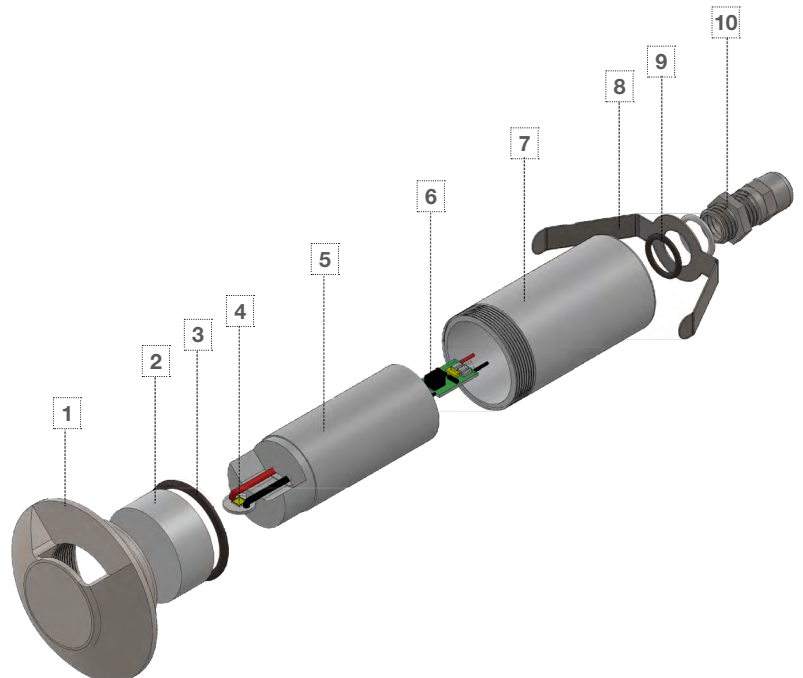

FP50 PLZ 1 Single Side lamp 	FP50 PLZ 2 Double Side lamp 	FP50 PLZ 4 Quadruple Side lamp 
---	--	--

CERTIFICAZIONI / CERTIFICATIONS

- | | |
|--|---|
| <ul style="list-style-type: none">• Soddisfa EN60598-1 e relative note• CE - conforme EN 60598-1• Apparecchio calpestabile• Può essere installato su superfici infiammabili• Norma CEI 34-156 Classe di isolamento: III• Conforme alla direttive RAEE - D.lgs 49/2014• Norma CEI 64-8 e relativi varianti: prodotto può essere installato su superfici infiammabili• Conforme alla direttive RAEE - D.lgs 49/2014• IEC/EN 62471:2010 Rischio fotobiologico: RG 1 | <p>Satisfies EN60598-1 and related notes
CE - compliance to EN 60598-1
Walkable spotlights
It can be installed on surfaces that are normally flammable
CEI 34-156 Insulation class: III
Compliance to the directive RAEE - D.lgs 49/2014
CEI 34-156 Insulation class: I/CEI 64-8 and variants: product can be installed on flammable surfaces
Compliance to the directive RAEE - D.lgs 49/2014
IEC/EN 62471:2010 Photobiological risk: RG 1</p> |
|--|---|

CODICI / CODE

Codice / Code	T°K
FP 50 PLZ 1	30K
FP 50 PLZ 1	40K
FP 50 PLZ 2	30K
FP 50 PLZ 2	40K
FP 50 PLZ 4	30K
FP 50 PLZ 4	40K

Controcassa / Outercasing

INC FP 50
